

Planning, Research, and Communications

Award of Excellence

Dasve Village Master Plan

Maharashtra, India

The HOK Planning Group

st. louis chapter - american society of landscape architects



Dasve Village Master Plan

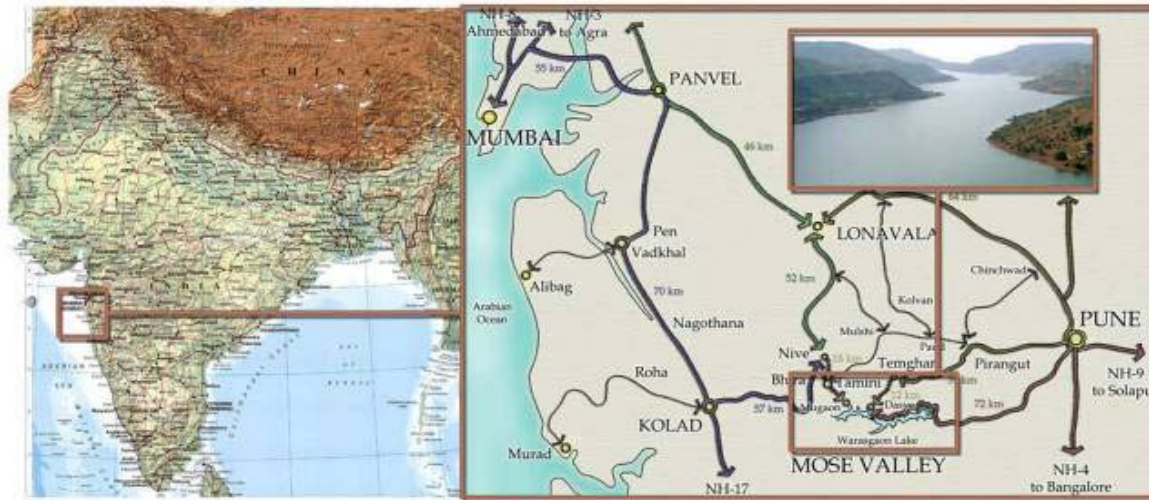

Dhamanhole Village



Dasve Village



Sakhari Plateau



Location

Dasve is a new village located on the banks of the Warasgaon Dam backwater in the Mose Valley - Pune district of the State of Maharashtra in India. The site is approximately 1,692 acres and resides within the Lavasa Hill Station, a development totaling more than 7000 acres in the Mose Valley. The Valley stretches about 15 km in length and 5 km in width. The main villages of the Lavasa project include: Dhamanhole in the west, Dasve in the central inland and Sakhari and Wadawali on the higher plateau in the south.

Character

The site is framed by forested ridges on all around, forming a linear valley with east-west orientation. Steep slopes create much of the valley walls, along with intermittent terraced areas. The land then becomes increasingly flat at the base of the hills. The valley has many rocky drainage channels and riparian corridors that converge into many streams that feed directly into the main lake. Several small waterfalls expose the volcanic rock below the surface of the soil. Over 400 meters of elevation change exist from the ridge tops to the High Water level of the Main lake.

Site Location & Character



asla

awards program 2005

Dasve Village Master Plan

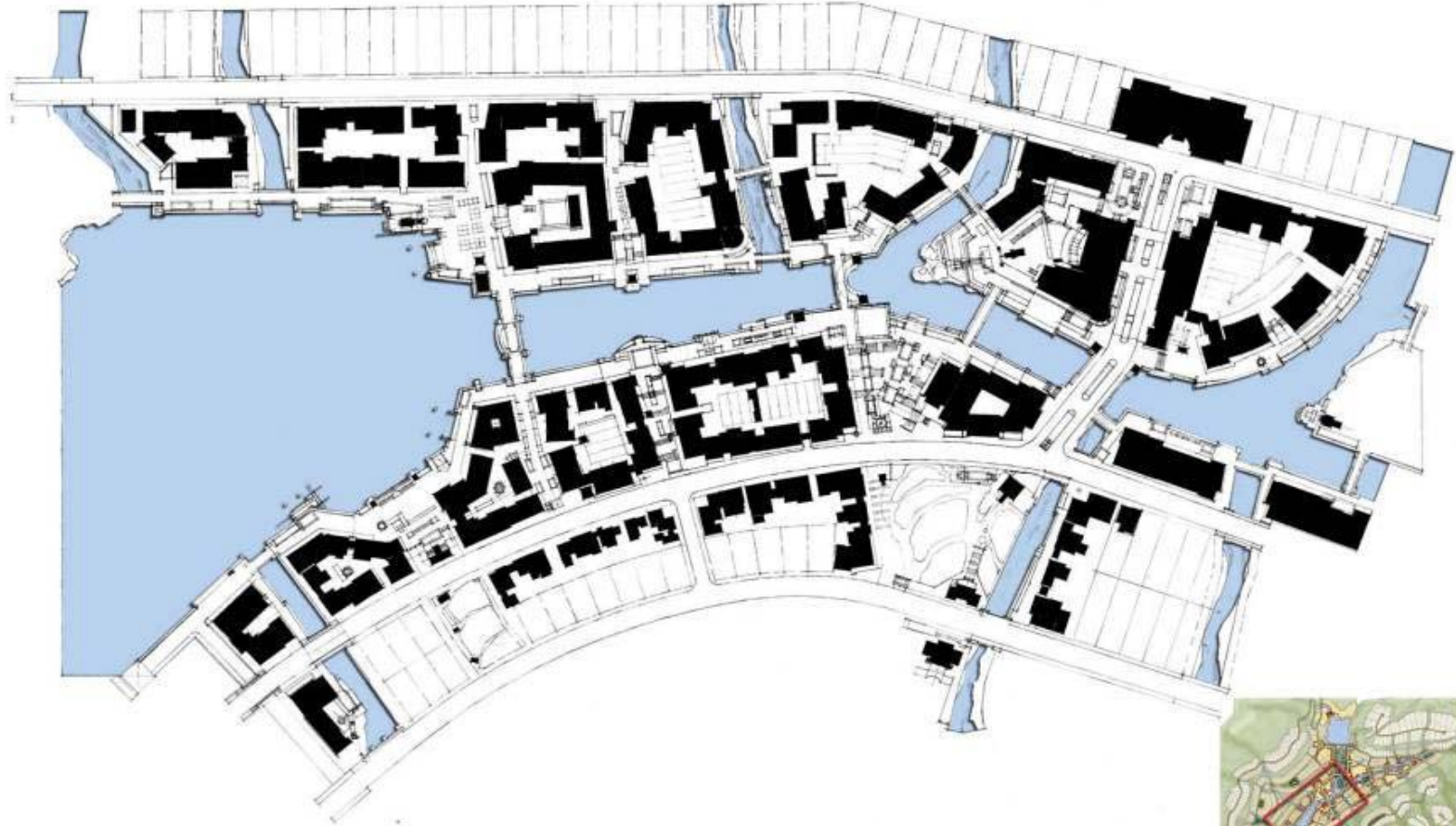

Dasve Town Center Plan



asla
awards program
2005

Dasve Village Master Plan



Dasve Town Center Aerial View



Dasve
Maharashtra, India

asla
awards program
2005

Dasve Village Master Plan

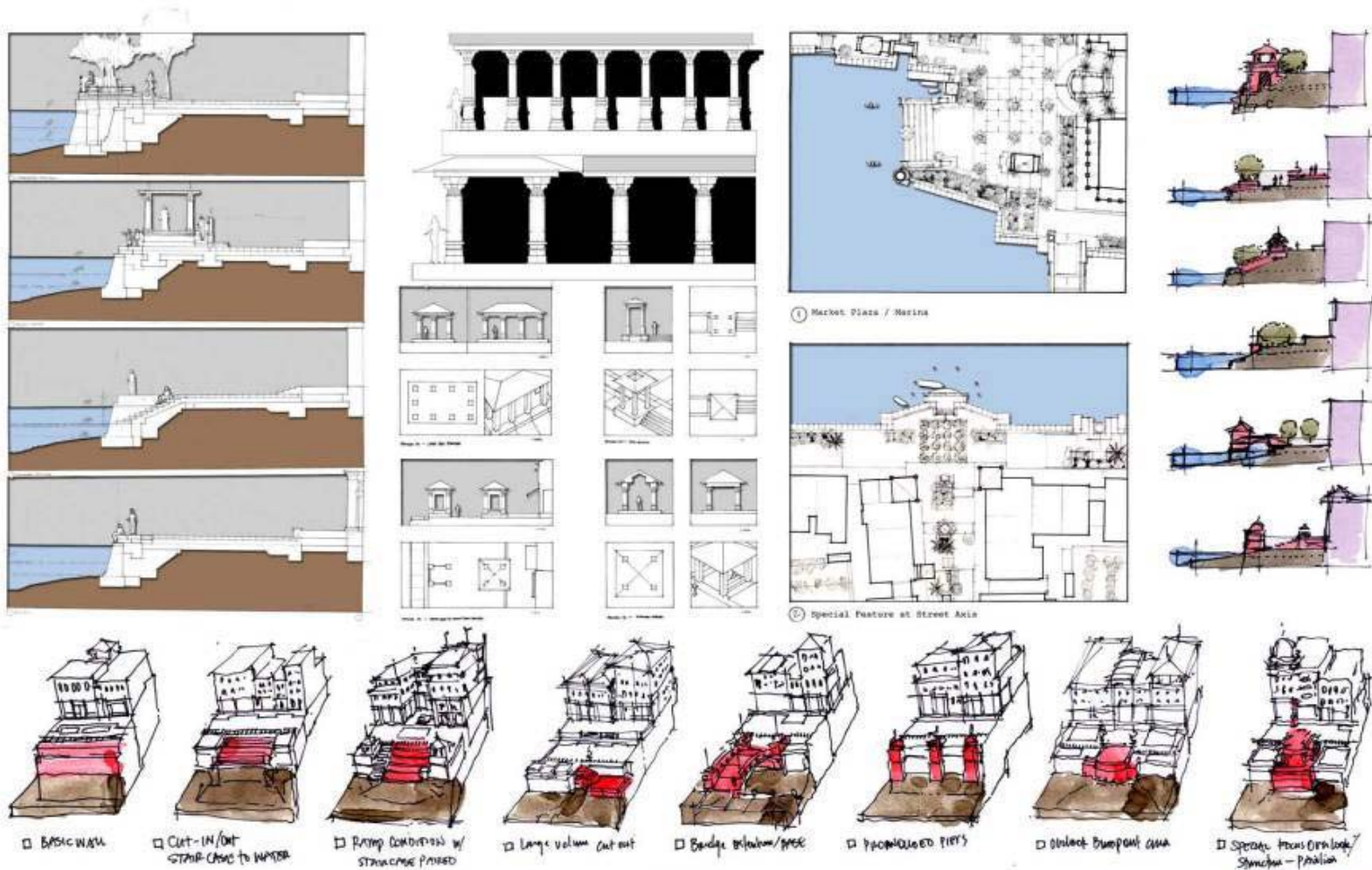

Lake Edge Treatment - Urban Condition



Dasve
Maharashtra, India

asla
 awards program
 2005

Dasve Village Master Plan

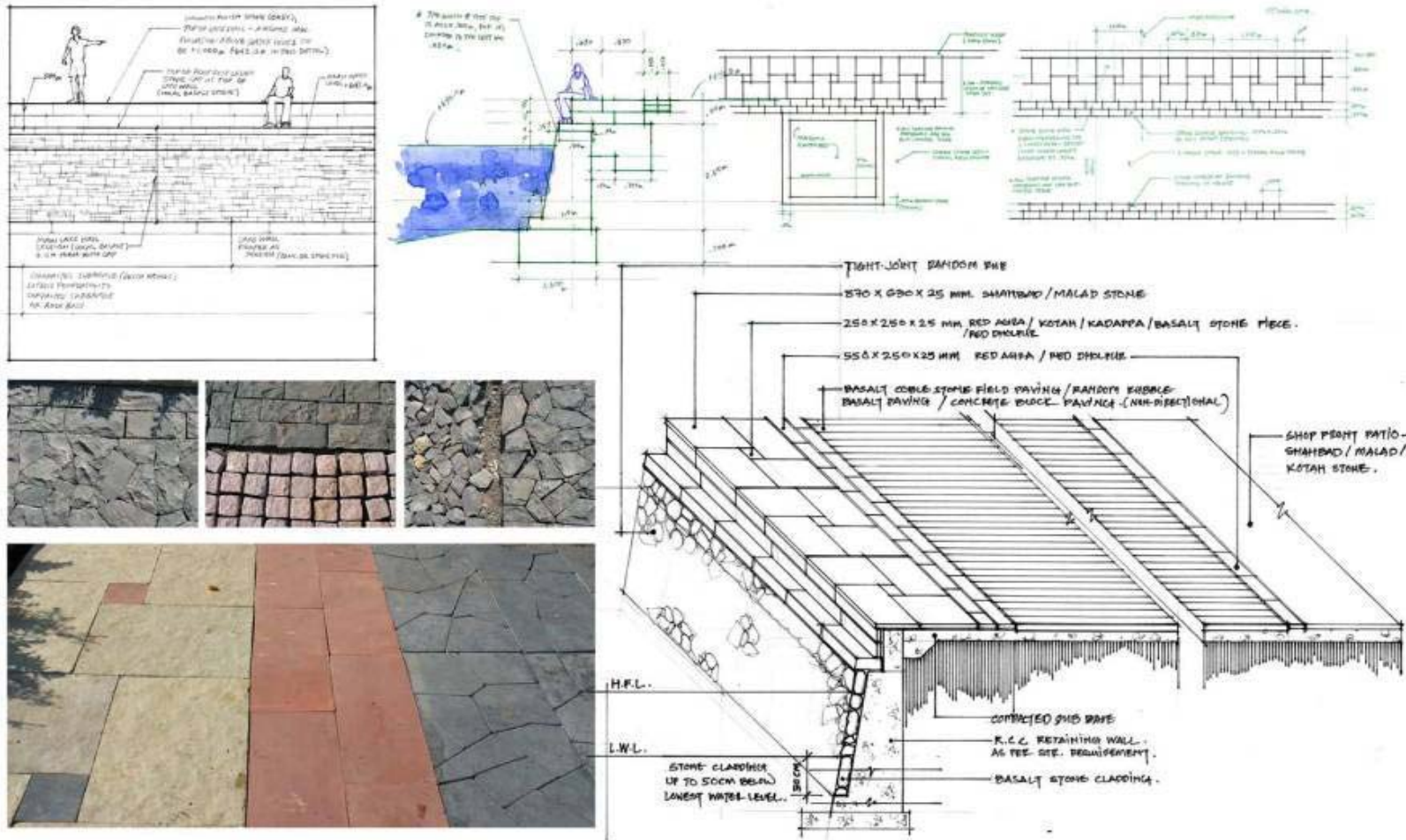

Lakefront Promenade - Material Palette



Dasve
Maharashtra, India

asla

awards program 2005